

**HIRING RATE SHEET FOR EXHIBITION 2018 (these rates are subject to change)**

<b>Rates</b>	<b>1/3 Gallery</b> 2 possible configurations  72sqmtrs approx  66sqmtrs approx	<b>2/3 Gallery</b> 2 possible configurations  126sqmtrs approx  120sqmtrs approx	<b>Full Gallery</b> 192sqmtrs approx.
<b>Group Rate</b>	\$1540/four week exhibition or* (\$385/week)  Plus 25% commission and bond	\$2470/four weeks exhibition* (\$617.50/week)  Plus 25% commission and bond	\$3820/ four week exhibition*(\$955/week)  Plus 25% commission and bond
<b>Single Artist Rate</b>	\$1120/four week exhibition * (\$280/week)  plus 25% commission on sales/plus bond	\$1720/four week exhibition* (430/week)  plus 25% commission on sales/plus bond	\$2770/four week exhibitoin* (\$692.50/week)  plus 25% commission on sales/plus bond
<b>Bond</b>	\$155	\$190	\$250

\* a week represents 6 days Monday – Friday 10am -4.30pm and Saturday 10am – 2.30pm.

PLEASE NOTE ONLY 4 week exhibitions accepted

## GALLERY LANE COVE

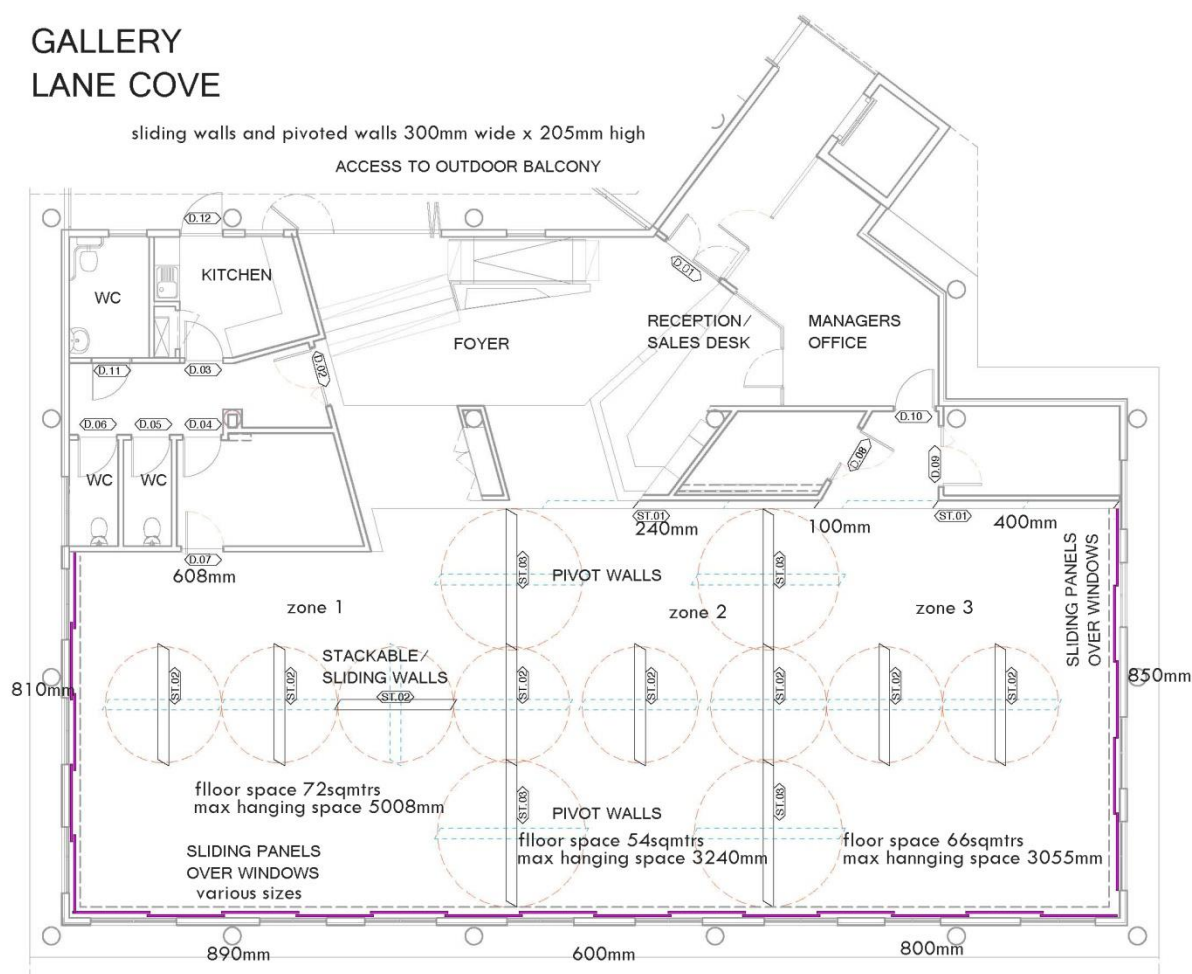

**Please note the dimensions should be in centimetres not millimetres as is shown in this document.**

Gallery Lane Cove is a very flexible space and has three different zones. Zone 1 OR Zone 3 can be booked out as the 1/3 space configuration. A combination of Zone 1 & Zone 2 OR Zone 2 & Zone 3 can be booked out as the 2/3 space.

The dimensions on this floor plan are approximate.

The central sliding walls and the 4 central pivot walls are 300mm wide and 205mm high. The sliding walls along the three boundary walls are all various sizes and cover the windows. The natural light can be modified depending on your requirements and all boundary spaces can be hung if required. The light temperature of gallery lights is 3000.

It is recommended that you visit the site to establish your requirements. Please contact the Manager to make an appointment 02 9428 4898 or [centrehouse@bigpond.com](mailto:centrehouse@bigpond.com).